

\* 所有原料材质, 生产制程, 电镀必须符合 ROHS 要求

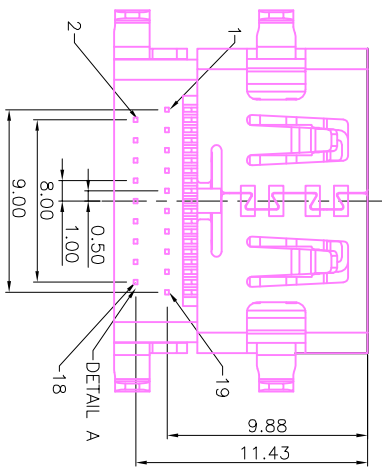

- MATERIALS**
1. HOUSING : THERMOPLASTIC (UL 94V-0).
  2. TERMINAL : COPPER ALLOY, GOLD PLATED ON CONTACT AREA, GOLD PLATED ON TAIL.
  3. SHELL : COPPER ALLOY, NICKEL PLATED OVERALL
- SPECIFICATION**
1. CURRENT RATING : 0.5 A. MAX.
  2. DIELECTRIC WITHSTANDING VOLTAGE : 500V AC R.M.S. FOR ONE MINUTE.
  3. INSULATION RESISTANCE : 1000MΩ MIN. AT 500V DC.
  4. CONTACT RESISTANCE : 30MΩ MAX.
  5. OPERATING TEMPERATURE : -25°C TO +85°C.

PIN	SIGNAL ASSIGNMENT	PIN	SIGNAL ASSIGNMENT	PIN	SIGNAL ASSIGNMENT
1	TMS Data1+	8	TMS Data0 Shield	15	SCL
2	TMS Data2 Shield	9	TMS Data0 -	16	SDA
3	TMS Data2-	10	TMS Data1+	17	DDC/GEC Ground
4	TMS Data1+	11	TMS Data1 Shield	18	+5V Power
5	TMS Data1 Shield	12	TMS Data0-	19	Hot Plug Detect
6	TMS Data1-	13	GEC		
7	TMS Data0-	14	Reserved (N.C. on device)		

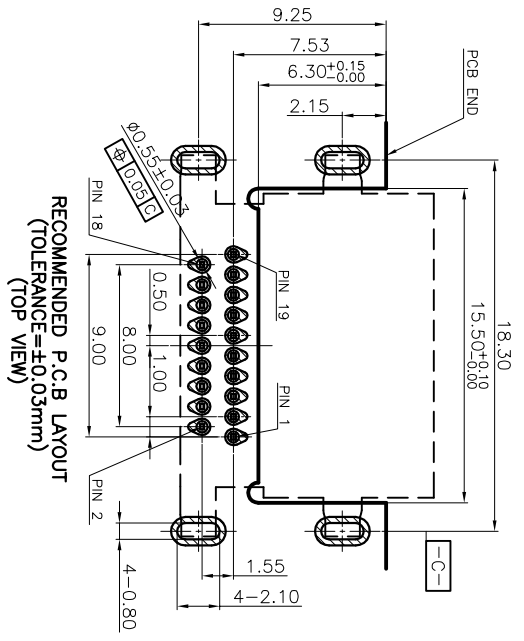
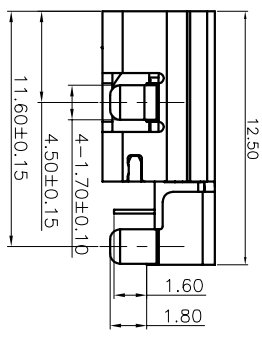
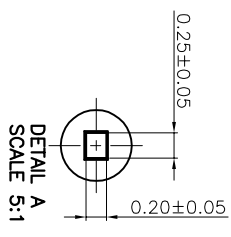
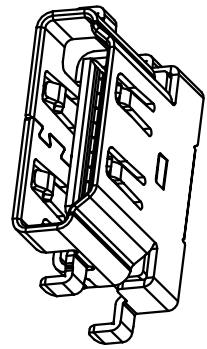
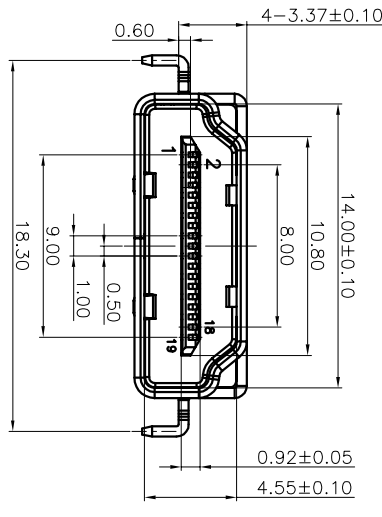
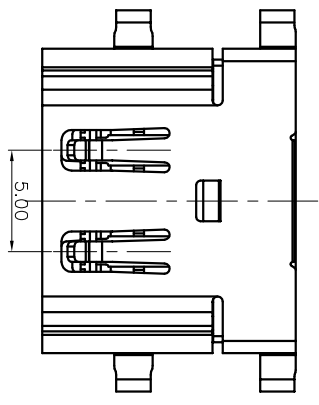

深圳市鑫南天科技有限公司  
Shen zhen Shi Xin Nan Tian Industrial Co., Ltd

PRODUCT NAME : HDMI A TYPE 反向视频板 37 外壳脚+端子脚DIP	DRAWING NO. : XNT-HDA-0101AAMCB337	CHECK : JANY	DATE : 2008/12/10
DIMENSIONS UNIT: mm UNLESS OTHERWISE SPECIFIABLE	DIMENSION TOLERANCE .0=±0.38 .00=±0.25 .000=±0.10 ANG.=±.3°	APPROVED : JEFF	DATE : 2008/12/10
REVISION NO. : 1	EGR NO. : 2	SCALE : 1:1	PAGE : 1 OF 1